

**VTUVIA®**  
RIDING IS THE SCENERY

# USER MANUAL



## V-SN100

Thank you for purchasing VTUVIA Electric Bikes, we are one of the best Ebike companies based on China.

VTUVIA produces High-quality Bikes&Considerate Service for every customers, to help them enjoy a good ring.

Before riding, please read the manual carefully, and carefully check the complete components to ensure your safety.

If you find damage on the surface or the corner, or you meet other problems, please contact the dealer or our company in time.

Contact information:  
info@vtuvia.com  
Tel: +86 519 8109 5767

## **IMPORTANT!**

THIS PRODUCT IS NOT INTENDED FOR OFF-ROADUSE.

YOUR INSURANCE POLICIES MAY NOT PROVIDE COVERAGEFOR ACCIDENTS INVOLVING THE USE.

OF THIS BICYCLE.

TO DETERMINE IF COVERAGE IS PROVIDED, YOU SHOULD CONTACT YOUR INSURANCE COMPANY.

# Main Technical Parameters And Specification

---

Motor:	48v 750w rear geared brushless
Battery:	48v/13AH Samsung li-ion battery
Controller:	48v 20A Intelligent brushless
PAS:	1 :1 intelligent pedal assistant system
Range:	22 miles(electric only), 35miles(pedal assistant)
Charging Time:	AC 100v-240v 1.8amps smart charger,5-6 hours
Rear Derailleur:	Shimano front 1 and rear 7 outer
Max Speed:	23-28MPH
Rear Lever:	Aluminum alloy mechanical disc brake
Tyres:	27.5*4.0 tyre
Frame:	6061 aluminium alloy folding
Front Fork:	suspension fork
Front Brake:	Karasawa disc brake
Rear Brake:	Karasawa disc brake
Frame:	27.5 inch Aluminium alloy
Stud:	Aluminium alloy folding
Display:	LCD
Chain:	KMC
Chain Wheel:	Aluminium alloy crank 44T
Seat Post:	Aluminium alloy
Foot:	Folding foot
Seat Cushion:	VELO
Shelves:	Rear rack
Colour:	Black
Net Weight:	60lbs
Gross Weight:	65 lbs
Max Load:	365 lbs

# LCD Display Instruction

## 1.Shell's Size and Material

The shell's material is ABS. LCD screen is made of imported high hardness acrylic, and the hardness is equal to tempered glass.

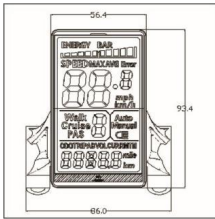

Front View

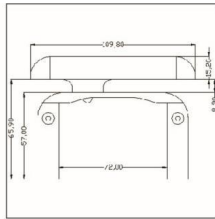

Side View

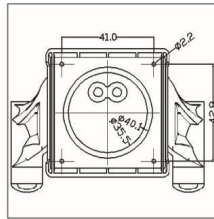

Front View of the Holder

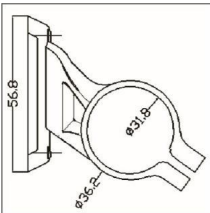

Side View of the Holder

# LCD Display Instruction

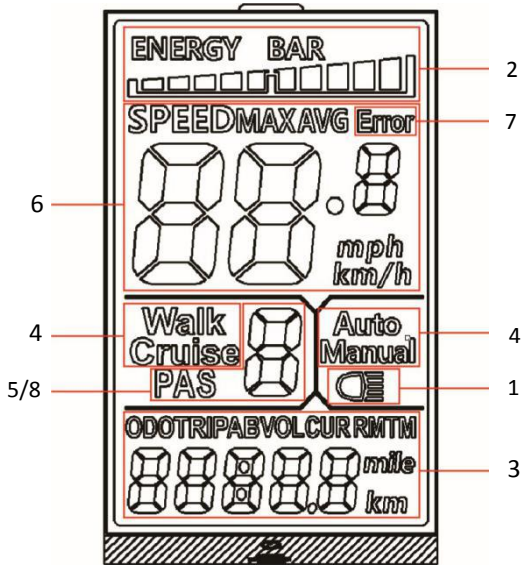

## 2.1 Headlight

## 2.2 Power status

## 2.3 Multi-functions

Total Distance(ODO), Single Trip Distance A/B(TRIPA/TRIPB), Voltage(VOL), Current(CUR), Real Miles(RM), Riding time(TM)

## 2.4 E-Bike Mode: Walk Cruise, Auto, Manual(not indicated)

## 2.5 Pedal assist adjust PAS grades: 0-3, 0-5(default) or 0-9 modes

## 2.6 Speed

Real speed(SPEED), Maximum speed(MAX), Average speed(AVG), MPH, KM/Hare both optional.

According Wheel size and signal data, the meter could figure out the real speed.

# LCD Display Instruction

---

## 2.7 Error display Meaning of Error Code:

Error Code	Error Status	Notes
0	Normal Status	
1	Save	
2	Brakes	
3	PAS promble(a riding mark)	not implemented
4	6KM/H cruising	
5	Real-time cruising	
6	Battery is undervoltage	
7	Motor's problem	
8	Throttle's problem	
9	Contrller's problem	
10	Communication Receiving problem	
11	Communicaton Sending problem	
12	BMS Communication problem	
13	Headlight problem	

## 2.8 PAS grades

PAS Status (0-9 grades), Cruise mark

# LCD Display Instruction

---

## 2.9 Parameters setting

P01 Background luminance. 1 is the darkest, 3 is the brightest.

P02 Unit of the mileage. 0 is KM, 1 is MILE.

P03 Voltage grades. 24V, 36V, 48V. The original voltage is 48V.

P04 Sleep time. 0 is without sleep, other numbers stand for the sleep time (1-60 min).

P05 PAS grades. 0-3, 0-5(default) or 0-9 modes for choice P06 Wheel size. Unit: inch.

Precision:

P07 Speed measuring magnet. Range: 1-255

P08 Speed limit. Range: 0-100km/h, 100 means without limit

No-Communication Status (controlled by the meter):

When the real speed is over the ones we set, the meter would shut off PWM output; when less than the speed we set, the meter would turn on PWM output automatically, the driving speed would be  $\pm 1$ km/h (Speed limit is both for PAS and Throttle)

Communication Status (Controlled by the controller):

The driving speed keeps the same with the ones we set. Random error:  $\pm 1$ km/h. (Speed limit is for both PAS and Throttle)

Notes: These data are based on KM. When changing KM to Mile, the speed value on the screen would convert to correct Miles automatically, but if you do not change the setting of speed limit from KM to Mile, it would be different from the real speed limit in Mile.

P09 Zero start & Non-zero Start. 0 is Zero Start, 1 is Non-zero Start

P10 Driving mode.

0 is driven by PAS. Throttle is useless at this time.

1 is driven by Throttle. PAS is useless at this time.

2 is driven by PAS & Throttle. Throttle is useless at Zero Start status.

P11 PAS sensitivity. Range: 1-24

P12 PAS start strength. Range: 0-5

P13 PAS magnet type. There are 3 types: 5, 8, and 12.

P14 The Current-limiting of Controller. The original Current is 12A. Range: 1-20A

P15 Not implemented now.

P16 Reset ODO. Long press "A" for 5s, ODO could be reset.

# LCD Display Instruction

---

## 3.Button Introductions

3.1 During riding, need change PAS/Speed grades, shortly press "A" "V"

3.2 During riding, need change data in Multi-function Area, shortly press "M"; Long press "M", could switch status between MODE and ON/OFF; Long press as a compound button, is mainly used for parameter setting, which could reduce misoperation due to complicated operation. (No compound button with short-time press, because it's difficult to operate.)

### 3.3 Specific operation explanations

#### 3.3.1 Change PAS grade

Suppose it's PAS mode now, shortly press "A", PAS grade +1, shortly press "V", PAS grade-1.

#### 3.3.2 Shift the speed display

Long press "M" + "A", to shift the way of speed display

#### 3.3.3 ON/OFF 6KM/H cruising, ON/OFF Headlight, Reset ODO

When e-bike stops, long press "V" to enter 6KM/H cruising mode. Stop pressing to exit the cruise mode; Long press "A" to turn ON/OFF Headlight and Taillight; At P16, long press "V" for 5s to reset ODO.

#### 3.3.4 ON/OFF the screen

Long press "M" to turn ON/OFF the screen.

#### 3.3.5 Change data in multi-function Area.

Shortly press "M" to change data.

#### 3.3.6 Parameters setting

Long press "A" + "V" to start setting parameters, such as wheel size (inch), background luminance... (Refer to P01-P16)

On the setting interface, shortly press "A", "V" or to plus/minus value. Parameters would be shining after modifying, choose the ones you prefer,

- a. Long press "M" to save the value, the shining would stop.
- b. Shortly press "M" to shift to the next parameter, and to save current values at the same time.
- c. Press "A" + "V" to exit setting parameters and to save values. If not press these buttons, it would exit and save parameters modified automatically 10s later.



# Connection diagram

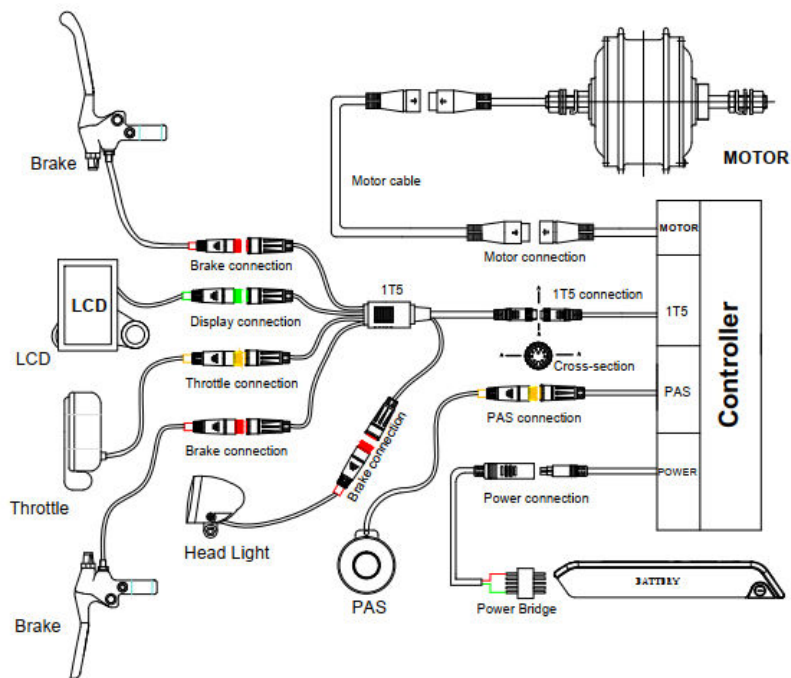

MODEL	SN100/MN100/SJ26
-------	------------------

VTUVIA

# IMPORTANT!

We reserve the right to make modifications to e-bike without prior notice.



*Riding is the scenery* Vtuvia ✓

Changzhou Vtuvia Electric Technology Co., Ltd.

Address: 9-1, Taihu East Road, Xinbei District, Changzhou, China

info@vtuvia.com

Tel: +86 519 8109 5767

www.vtuvia.com